

External Gear- Reducing Motorised Drum



The ELITE YTH model motorised drum is designed for operation in temperatures of -20°C to $+40^{\circ}\text{C}$, and is suitable also for installation in conveyors where the conveyed material exceeds 60°C . Operation in work environments at altitudes up to 1000 meters is also possible.

With its European design technology background, the YTH model consists of a pulley, connected to a drive and electric motor, featuring hardened gears for its planetary gear drive.

Low noise, high capacity with over-load and large power range.

Drum Dia. D mm	Belt Width B mm	Power P kW	V m/s Velocity of drum surface											
			0.32	0.4	0.5	0.63	0.8	1.0	1.25	1.6	2.0	2.5	3.15	4.0
Ø 320	400 500 650 800	2.2 30 4.0			✓	✓	✓	✓	✓	✓	✓			
		5.5 7.5						✓	✓	✓	✓	✓		
Ø 400	400 500 650 800	2.2 30 4.0	✓	✓	✓	✓	✓	✓	✓	✓	✓			
		5.5 7.5					✓	✓	✓	✓	✓	✓		
Ø 500	500 650 800 1000	2.2 30 4.0	✓	✓	✓	✓	✓	✓	✓	✓	✓			
		5.5 7.5	✓	✓	✓	✓	✓	✓	✓	✓	✓	✓	✓	
		11 15				✓	✓	✓	✓	✓	✓	✓	✓	✓
		18.5 22 30 37					✓	✓	✓	✓	✓	✓	✓	✓
Ø 630	650 800 1000 1200 1400 1600 1800 2000	5.5 7.5	✓	✓	✓	✓	✓	✓	✓	✓	✓	✓	✓	
		11 15				✓	✓	✓	✓	✓	✓	✓	✓	✓
	650 800 1000 1200 1400 1600 1800 2000	18.5 22 30 37						✓	✓	✓	✓	✓	✓	✓
		45 55						✓	✓	✓	✓	✓	✓	✓
Ø 800	800 1000 1200 1400 1600	5.5 7.5				✓	✓	✓	✓	✓	✓	✓		
		11 15					✓	✓	✓	✓	✓	✓	✓	✓
	800 1000 1200 1400 1600 1800 2000	18.5 22 30 37							✓	✓	✓	✓	✓	✓
		45 55							✓	✓	✓	✓	✓	✓
		75 90 110 132							✓	✓	✓	✓	✓	✓
		160 200								✓	✓	✓	✓	✓
Ø 1000	1000 1200 1400 1600 1800 2000	30 37								✓	✓	✓	✓	✓
		45 55								✓	✓	✓	✓	✓
		75 90 110 132								✓	✓	✓	✓	✓
		160 200									✓	✓	✓	✓

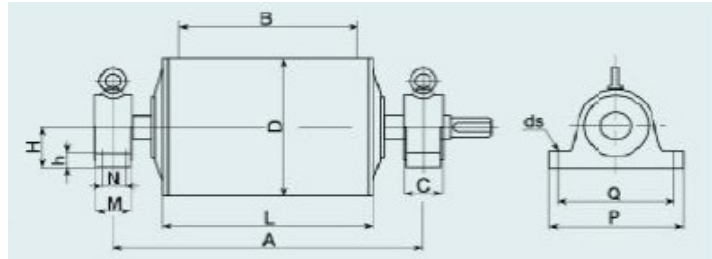

Mounting External Size

D	B	A	L	H	C	M	N	P	Q	h	ds
Ø 320 Ø 400	400	750	500	120	110	90	-	340	280	35	Ø27
	500	850	600								
	650	1000	750								
	800	1300	950								
Ø 500	500	850	620	120	120	90	-	340	280	35	Ø27
	650	1000	750								
	800	1300	950								
	1000	1500	1150								
Ø 630 Ø 800 Ø 1000	650	1000	750	120	120	90	-	340	280	35	Ø27
	800	1300	950	140	140	130	80	400	330	35	Ø27
	1000	1500	1150	160	160	150	90	440	360	50	Ø34
	1200	1750	1400								
	1400	2000	1600								
	1600	2200	1800								
	1800	2400	2000								
	2000	2600	2200								

Order Symbol

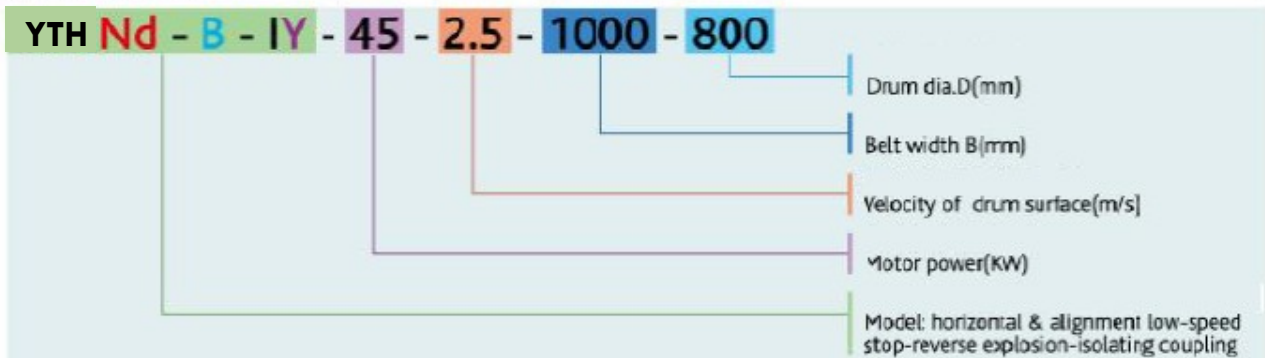

Notes:

1. If you need to stop-reverse motorised drum with rotating direction different from the above, this must be given at the time of enquiry/order.
2. Please note the type of YTH-III in your enquiry, as it is divided into four types.
3. If the drum surface needs to be rubber covered, or covered in other materials, this must be specified in the enquiry/order.

YT Model

High Performance Motorised Drum

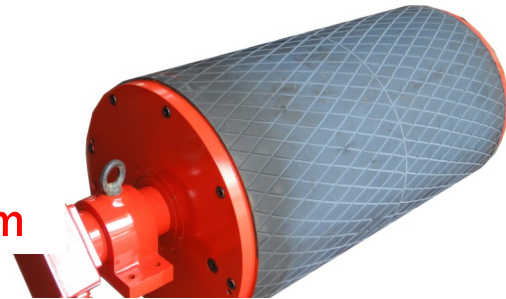

The ELITE YT model motorised drum (oil-filled) is a product developed for medium to large type belt conveyors, it's background of European Technology provides high-precision advanced planetary gearing and low noise advantages.

Fully sealed, the YT motorised drum is suitable for operation in humid, dusty environments and high load conditions, suitable for driving conveyors in machinery such as stackers, reclaimers, mining, plant and out-loading conveyors at port facilities.

YT Model Parameter List

Drum dia. D mm	Power P KW	Belt Width B mm	Velocity of drum surface V(m/s)						Mass M kg	
			1.0	1.25	1.6	2.0	2.5	3.15		4.0
Ø 630	18.5	800	○	○	○	○	○	○	○	1200/1250/1350/1450
		1000	○	○	○	○	○	○	○	1250/1300/1400/1500
		1200	○	○	○	○	○	○	○	1300/1350/1450/1550
		1400	○	○	○	○	○	○	○	1350/1400/1500/1600
		1600	○	○	○	○	○	○	○	1400/1450/1550/1650
Ø 800	18.5	800		○	○	○	○	○	○	1270/1320/1420/1520
		1000		○	○	○	○	○	○	1320/1370/1470/1570
		1200		○	○	○	○	○	○	1370/1420/1520/1620
		1400		○	○	○	○	○	○	1420/1470/1570/1670
		1600		○	○	○	○	○	○	1470/1520/1620/1720
	45	1000		○	○	○	○	○	○	2080/2130
		1200		○	○	○	○	○	○	2200/2250
		1400		○	○	○	○	○	○	2320/2370
		1600		○	○	○	○	○	○	2440/2490
		1800		○	○	○	○	○	○	2560/2610
	55	2000		○	○	○	○	○	○	2680/2730
		1200				○	○	○	○	2250
		1400				○	○	○	○	2370
		1600				○	○	○	○	2490
		1800				○	○	○	○	2610
75	2000				○	○	○	○	2730	
	45	1000			○	○	○	○	○	2150/2200
		1200			○	○	○	○	○	2300/2350
		1400			○	○	○	○	○	2500/2550
		75	1000					○	○	○
1200							○	○	○	2350
1400						○	○	○	2550	
1600						○	○	○	2750	
1800						○	○	○	2950	
Ø1000	2000					○	○	○	3150	

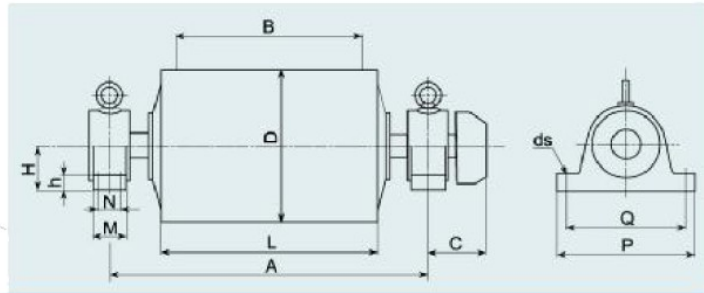

Mounting External Size

D	B	A	L	H	M	N	P	Q	h	ds	E
Ø 630 Ø 800 Ø 1000	800	1300	950	140	130	80	400	330	50	Ø 27	260 (≤ 37kW) 280 (> 45kW)
	1000	1500	1150								
	1200	1750	1400	160	150	90	440	360	50	Ø 34	
	1400	2000	1600								
	1600	2200	1800								
	1800	2400	2000								
2000	2600	2200									

Order Symbol

YT - 22 - 2.5 - 1000 - 800

- YT: EHP model oil-filled motorised drum
- 22: Drum power P(KW)
- 2.5: Velocity of drum surface(m/s)
- 1000: Belt width B(mm)
- 800: Drum Dia.D(mm)

Notes:

- The YT type oil-filled motorised drum can be made to operate in only one direction if required.
- The YT type oil-filled motorised drum can be made to meet special requirements of our

TDY Model Motorised Drum



The ELITE TDY model motorised drum (oil-filled) is widely installed in general purpose conveying, light-medium duty applications as a cost effective drive system offering a wide range of power and belt speeds.



ELITE
MOTORISED DRUM

TDY Model Parameter List

Drum dia. D mm	Power P KW	Belt Width B mm	Velocity of drum surface V(m/s)											Mass M kg		
			0.25	0.32	0.4	0.5	0.63	0.8	1.0	1.25	1.6	2.0	2.5		3.15	
∅ 320	1.5/2.2	500				○	○	○	○	○	○	○				130
		650				○	○	○	○	○	○	○				140
		800				○	○	○	○	○	○	○				150
	3/4	500				○	○	○	○	○	○	○				140/150
		650				○	○	○	○	○	○	○				150/160
		800				○	○	○	○	○	○	○				160/170
∅ 400	2.2/3	500	○	○	○	○	○	○	○	○	○	○				216/248
		650	○	○	○	○	○	○	○	○	○	○				227/262
		800	○	○	○	○	○	○	○	○	○	○				248/267
	4	500	○	○	○	○	○	○	○	○	○	○				253
		650	○	○	○	○	○	○	○	○	○	○				267
		800	○	○	○	○	○	○	○	○	○	○				271
∅ 500	2.2/3	500	○	○	○	○	○	○	○	○	○	○				271/298
		650	○	○	○	○	○	○	○	○	○	○				282/313
		800	○	○	○	○	○	○	○	○	○	○				312/343
		1000	○	○	○	○	○	○	○	○	○	○				350/365
	4/5.5	500		○	○	○	○	○	○	○	○	○				305/365
		650		○	○	○	○	○	○	○	○	○		○		319/401
		800		○	○	○	○	○	○	○	○	○		○		349/430
	7.5/11	1000		○	○	○	○	○	○	○	○	○		○		365/442
		650				○	○	○	○	○	○	○		○		415/475
		800				○	○	○	○	○	○	○		○		442/512
		1000				○	○	○	○	○	○	○		○		470/550
	15	800					○	○	○	○	○	○		○		536
		1000						○	○	○	○	○		○		575
	18.5	800						○	○	○	○	○		○		575
		1000							○	○	○	○		○		615
22	800								○	○	○		○		585	
	1000									○	○		○		625	
∅ 630	3/4	800		○	○	○	○	○	○	○	○					495/502
		1000		○	○	○	○	○	○	○	○					526/533
		1200		○	○	○	○	○	○	○	○	○				580/587
	5.5	800		△	△	△	○	○	○	○	○	○		○		572
		1000		△	△	△	○	○	○	○	○	○		○		603
		1200		△	△	△	○	○	○	○	○	○		○		673
	7.5/11	650		△	△	△	○	○	○	○	○	○		○		520/608
		800		△	△	△	○	○	○	○	○	○		○		587/674
		1000		△	△	△	○	○	○	○	○	○		○		618/706
		1200		△	△	△	○	○	○	○	○	○		○		687/776
	15	1400		△	△	△								○		765/854
		800					○	○	○	○	○	○		○		692
		1000					○	○	○	○	○	○		○		724
		1200						○	○	○	○	○		○		794
		1400						○	○	○	○	○		○		870
		800							○	○	○	○		○		730
		1000								○	○	○		○		762
	1200									○	○		○		832	
	18.5	1400								○	○			○		910
		800									○	○		○		740
		1000										○	○		○	772
1200												○	○		842	
22	1400												○		920	
	1000													○	950/980	
	1200													○	1020/1050	
	1400													○	1100/1130	
30/37	1000													○	1010	
	1200													○	1090	
	1400													○	1150	
∅ 800	7.5/11	1400					○	○	○	○	○	○	○	○	886/957	
		1400					○	○	○	○	○	○	○	○	975	
	18.5/22	1400					○	○	○	○	○	○	○	○	1015/1025	
		1000								○	○	○	○	○	1020/1050	
	30/37	1200									○	○	○	○	1090/1120	
		1400										○	○	○	1170/1200	
45	1000										○	○	○	1080		
	1200											○	○	1160		
		1400										○	○	1230		

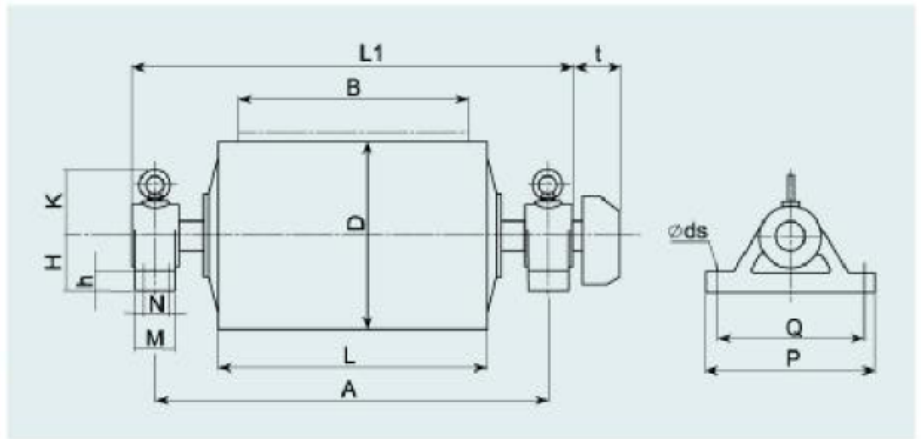
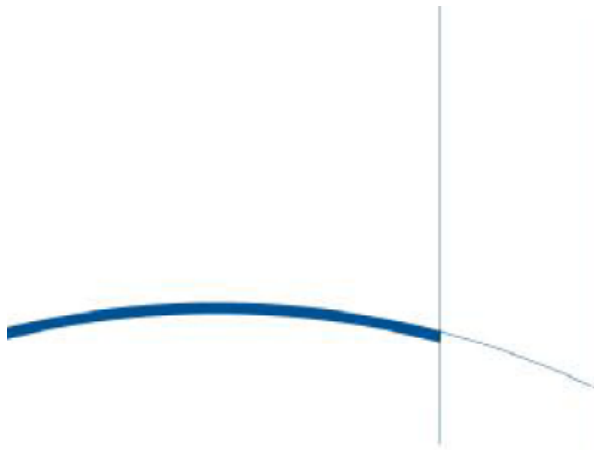

Mounting External Size

D	B	A	L	L1	t	H	K	M	N	P	Q	h	ds
Ø 320	500	850	600	920	95	120	125	70	-	340	280	35	Ø27
	650	1000	750	1070									
	800	1300	950	1220									
Ø 400	500	850	600	940	95	120	125	90	-	340	280	35	Ø27
	650	1000	750	1090									
	800	1300	950	1240									
Ø 500	500	850	600	960	115	100	145	70	-	340	280	35	Ø27
			620										
	650	1000	750	1120		120	90	-	340	280	35	Ø27	
	800	1300	950	1420									
Ø 630	650	1000	750	1120	115	120	175	90	-	340	280	35	Ø27
	800	1300	950	1430									
	1000	1500	1150	1630		160	180	150	90	440	360	50	Ø34
1200	1750	1400	1900										
Ø 800	1400	2000	1600	2150									

Order Symbol

TDY - 11 - 1.6 - 650 - 500

Drum Dia.D(mm)

Belt width B(mm)

Velocity of drum surface(m/s)

Drum power P(KW)

TDY model oil-filled motorised drum

YD Model

Oil-Filled Motorised Drum

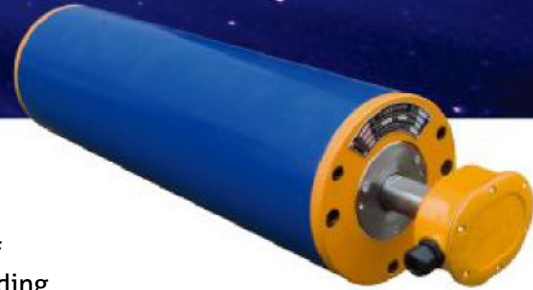

The ELITE YD model motorised drum (oil-filled) is a design of proven European technology, having many advantages including high-efficiency, light weight, low noise, long service life and is widely used in applications including the food industry, postal departments, airport luggage handling, and other light industrial applications.

YD Model Technical Information

Drum Dia. D mm	Power P KW	Velocity of drum surface V m/s				50mm 50mm Mass	
		mm	mm	kg	kg		
Ø 110	0.12	0.14, 0.16, 0.20, 0.25, 0.57, 0.63, 0.80		310	350	12	0.8
		0.04, 0.047, 0.05, 0.055, 0.06, 0.065, 0.07, 0.075, 0.08, 0.09, 0.10, 0.12, 0.152, 0.20		350	350	16	1.1
	0.25	0.25, 0.30, 0.32, 0.34, 0.38, 0.44, 0.53		320	350	17	1.5
Ø 130	0.25	0.046, 0.056, 0.065, 0.07, 0.08, 0.10, 0.13, 0.15, 0.18, 0.226		350	350	17	1.5
		0.29, 0.35, 0.40, 0.45, 0.52, 0.63		320	350	17	1.5
	0.55	0.046, 0.056, 0.058, 0.068, 0.071, 0.08, 0.09, 0.10, 0.12, 0.14, 0.15, 0.18, 0.226		400	400	19	1.5
		0.29, 0.35, 0.40, 0.45, 0.52, 0.63		370	400	19	1.5
Ø 174	0.75	0.03, 0.04, 0.05, 0.063, 0.08, 0.10, 0.13, 0.16, 0.20 扭矩250NM		470	500	50	1.8
		0.25, 0.32, 0.40, 0.50, 0.63, 0.80, 1.00, 1.25, 1.60, 2.00		400	400	40	
Ø 216	0.75	0.05, 0.063, 0.08, 0.10, 0.13, 0.16, 0.20, 0.25 扭矩250NM		470	500	70	2.5
		0.32, 0.40, 0.50, 0.63, 0.80, 1.00, 1.25, 1.60, 2.00, 2.50		400	400	60	
	1.1	0.13, 0.16, 0.20, 0.25, 0.32, 0.40, 0.50, 0.63, 0.80, 1.00, 1.25, 1.60, 2.00, 2.50		410	450	63	
	1.5/2.2	0.13, 0.16, 0.20, 0.25, 0.32, 0.40, 0.50, 0.63, 0.80, 1.00, 1.25, 1.60, 2.00, 2.50		460	500	69	
Ø 240	0.75	0.056, 0.07, 0.089, 0.11, 0.14, 0.18, 0.22, 0.28, 0.36 扭矩250NM		470	500	80	2.8
		0.44, 0.56, 0.70, 0.89, 1.11, 1.39, 1.78, 2.22, 2.78		400	400	70	
	1.1	0.14, 0.18, 0.2, 0.25, 0.4, 0.5, 0.56, 0.63, 0.8, 1.0, 1.25, 1.6, 2.0, 2.5		410	450	70	
	1.5/2.2	0.14, 0.18, 0.2, 0.25, 0.4, 0.5, 0.56, 0.63, 0.8, 1.0, 1.25, 1.6, 2.0, 2.5		460	500	78	
	3	0.14, 0.18, 0.2, 0.25, 0.4, 0.5, 0.56, 0.63, 0.8, 1.0, 1.25, 1.6, 2.0, 2.5		510	550	81	
Ø 320	1.1	0.13, 0.16, 0.20, 0.25, 0.32, 0.40, 0.50, 0.63, 0.80, 1.00, 1.25, 1.60, 2.00, 2.50		420	450	120	3.2
	1.5/2.2	0.13, 0.16, 0.20, 0.25, 0.32, 0.40, 0.50, 0.63, 0.80, 1.00, 1.25, 1.60, 2.00, 2.50		470	500	126	
	3	0.13, 0.16, 0.20, 0.25, 0.32, 0.40, 0.50, 0.63, 0.80, 1.00, 1.25, 1.60, 2.00, 2.50		520	550	132	
	4	0.25, 0.32, 0.40, 0.50, 0.63, 0.80, 1.00, 1.25, 1.60, 2.00, 2.50, 3.15		560	600	150	
	5.5	0.25, 0.32, 0.40, 0.50, 0.63, 0.80, 1.00, 1.25, 1.60, 2.00, 2.50, 3.15		560	600	155	
	7.5	0.50, 0.63, 0.80, 1.00, 1.25, 1.60, 2.00, 2.50, 3.15		660	700	160	
Ø 400	1.1	0.16, 0.20, 0.25, 0.32, 0.40, 0.50, 0.63, 0.80, 1.00, 1.25, 1.60, 2.00, 2.50		420	450	140	5.0
	1.5/2.2	0.16, 0.20, 0.25, 0.32, 0.40, 0.50, 0.63, 0.80, 1.00, 1.25, 1.60, 2.00, 2.50		470	500	145	
	3	0.16, 0.20, 0.25, 0.32, 0.40, 0.50, 0.63, 0.80, 1.00, 1.25, 1.60, 2.00, 2.50		520	550	152	
	4	0.32, 0.40, 0.50, 0.63, 0.80, 1.00, 1.25, 1.60, 2.00, 2.50, 3.15, 4.00		560	600	170	
	5.5	0.32, 0.40, 0.50, 0.63, 0.80, 1.00, 1.25, 1.60, 2.00, 2.50, 3.15, 4.00		560	600	175	
7.5	0.63, 0.80, 1.00, 1.25, 1.60, 2.00, 2.50, 3.15, 4.00		660	700	190		

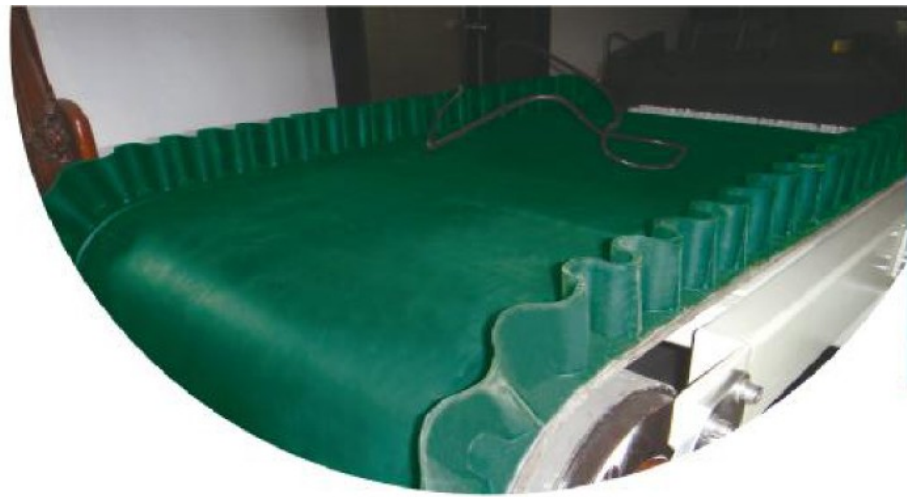

Mounting External Size

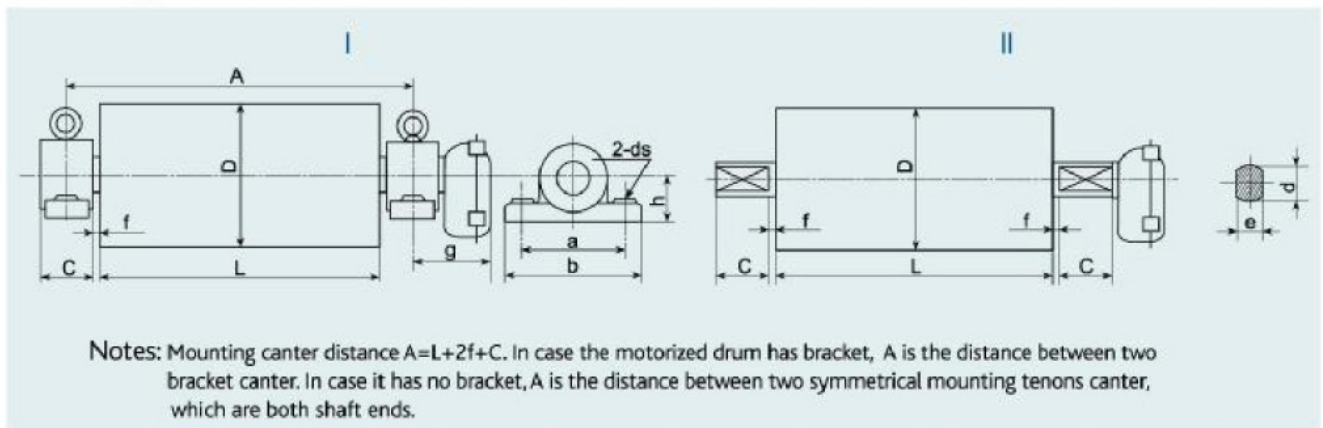

D	a	b	c	d	e	f	g	h	ds
Ø110	-	-	20	25	21	5	-	-	-
Ø130	-	-	20	25	21	5	-	-	-
Ø174	120	160	60	32	25	5	125	50	15
Ø216	120	160	60	38	30	5	125	50	15
Ø240	120	160	60	38	30	5	125	50	15
Ø320	210	260	60	42	35	10	125	95	19
Ø400	210	260	60	42	35	10	125	95	19

Notes: The mounting size of the motorized drum which power is 0.75KW, drum diameter is 216mm or 240mm is the same as the mounting size of the motorized drum which drum diameter is 174mm.

Order Symbol

YD - I - 2.2 - 0.6 - 500 - 216

- Drum Dia.D(mm)
- Drum length L(mm)
- Velocity of drum surface(m/s)
- Drum power P(KW)
- I mounting brackets, II no bracket
- YD type oil-seeped motorized drum

DY Model

Motorised Drum



The ELITE DY model motorised drum (oil-filled) is designed as a compact drive system for use in compact light-medium duty conveyor applications such as portable conveyors where reliability in a compact, safe, light weight drive system is required.

DY Model Parameter List

Drum Dia. D mm	Power P KW	Belt Width B mm	Velocity of drum surface V (m/s)						Mass M kg
			0.63	0.8	1.0	1.25	1.6	2.0	
Ø240	1.1	400	○	○	○	○	○	○	70
		500	○	○	○	○	○	○	76
		650	○	○	○	○	○	○	86
	1.5	400	○	○	○	○	○	○	75
		500	○	○	○	○	○	○	81
		650	○	○	○	○	○	○	91
	2.2	400	○	○	○	○	○	○	75
		500	○	○	○	○	○	○	81
		650	○	○	○	○	○	○	91
	3	500	○	○	○	○	○	○	81
		650	○	○	○	○	○	○	91
	Ø320	1.5	500		○	○	○	○	○
650				○	○	○	○	○	141
2.2		500		○	○	○	○	○	130
		650		○	○	○	○	○	141
3		500		○	○	○	○	○	132
		650			○	○	○	○	144
4		500			○	○	○	○	148
		650			○	○	○	○	158
5.5		500					○	○	153
		650		○	○	○	○	○	163
Ø400	3	500		○	○	○	○	○	152
		650		○	○	○	○	○	170
	4	500		○	○	○	○	○	166
		650		○	○	○	○	○	183
	5.5	500				○	○	○	171
		650		○	○	○	○	○	188
	7.5	650				○	○	○	190

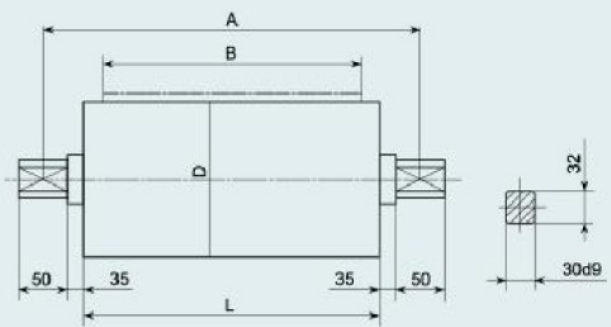

Mounting External Size

D	B	L	A
∅ 240	400	460	580
	500	560	680
	650	730	850
∅ 320	500	560	680
	650	730	850
∅ 400	500	560	680
	600	730	850

Order Symbol

DY1 - 2.2 - 1.6 - 500 - 240

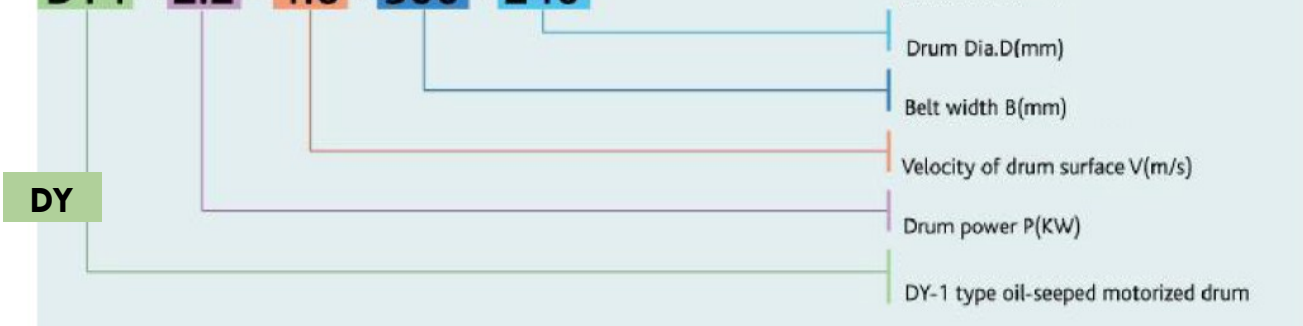

Factory 2,
27-28 Carl Court
Hallam, Victoria, Australia, 3803

PO Box 5057
Hallam, Victoria, Australia 3803

(+61) 3 9702 4502
sales@tssco.com.au
www.tssco.com.au